

DEPARTMENT OF HEALTH AND HUMAN SERVICES
DIVISION OF HEALTH SERVICE REGULATION

ROY COOPER
GOVERNOR

MANDY COHEN, MD, MPH
SECRETARY

MARK PAYNE
DIRECTOR

September 1, 2017

Catharine W. Cummer, Regulatory Counsel, Strategic Planning
Duke University Health System
3100 Tower Blvd, Suite 1300
Durham NC 27707

Exempt from Review

Record #: 2376
Facility Name: Duke Raleigh Hospital
FID #: 923421
Business Name: Duke University Health System
Business #: 640
Project Description: Construction of a connector between the main hospital and MOB 7
County: Wake

Dear Ms. Cummer:

The Healthcare Planning and Certificate of Need Section, Division of Health Service Regulation (Agency), determined that based on your letter of August 28, 2017, the above referenced proposal is exempt from certificate of need review in accordance with N.C. Gen. Stat. §131E-184(g). Therefore, you may proceed to offer, develop or establish the above referenced project without a certificate of need.

However, you need to contact the Agency's Construction and Acute and Home Care Licensure and Certification Sections to determine if they have any requirements for development of the proposed project.

It should be noted that this determination is binding only for the facts represented by you. Consequently, if changes are made in the project or in the facts provided in your correspondence referenced above, a new determination as to whether a certificate of need is required would need to be made by the Agency. Changes in a project include, but are not limited to: (1) increases in the capital cost; (2) acquisition of medical equipment not included in the original cost estimate; (3) modifications in the design of the project; (4) change in location; and (5) any increase in the number of square feet to be constructed.

HEALTHCARE PLANNING AND CERTIFICATE OF NEED SECTION

WWW.NCDHHS.GOV

TELEPHONE 919-855-3873

LOCATION: EDGERTON BUILDING • 809 RUGGLES DRIVE • RALEIGH, NC 27603

MAILING ADDRESS: 2704 MAIL SERVICE CENTER • RALEIGH, NC 27699-2704

AN EQUAL OPPORTUNITY/ AFFIRMATIVE ACTION EMPLOYER

Ms. Cummer
September 1, 2017
Page 2

If you have any questions concerning this matter, please feel free to contact this office.

Sincerely,

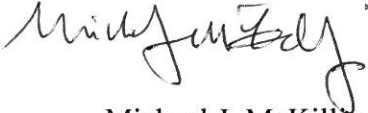

Michael J. McKillip
Project Analyst



Martha J. Frisone
Chief, Healthcare Planning and
Certificate of Need Section

cc: Construction Section, DHSR
Acute and Home Care Licensure and Certification Section, DHSR
Paige Bennett, Assistant Chief, Healthcare Planning, DHSR

Duke University Health System

Catharine W. Cumber
Regulatory Counsel, Strategic Planning

August 28, 2017

Via Electronic Mail

Ms. Martha Frisone
Certificate of Need Section
Division of Health Service Regulation
2704 Mail Service Center
Raleigh, NC 27699-2704

Re: Exemption Notice/Duke Raleigh Hospital

Dear Ms. Frisone:

The purpose of this letter is to provide notice of a construction and renovation project at Duke Raleigh Hospital and to request confirmation that this planning project is exempt from certificate of need review. Duke anticipates that it may spend more than \$2 million to renovate, replace and/or expand portions of the existing hospital facility located on the main campus. Specifically, Duke plans to build a structure connecting the existing main hospital building and Medical Office Building 7, which houses the hospital's oncology services, including chemotherapy and radiation oncology services. This construction will maximize coordination with other oncology services for enhanced patient and provider convenience. It will also provide a conditioned connection between the hospital and MOB 7, which will create a route for transporting patients from the hospital to MOB 7 for services located in that building. In addition to being more comfortable, efficient, and private for patients, it will also allow greater flexibility in the future about treating inpatients in MOB 7.

Duke has separately filed a CON application to acquire a PET/CT scanner that it proposes to install in this newly constructed space. If that application were denied, however, Duke would nonetheless proceed with this construction and use that space for other clinical and administrative purposes. Other than the proposed PET/CT scanner, this project does not relate to any planned change in licensed bed capacity or the addition of any health service facility or new institutional health services other than that allowed in GS 131E-176(b). Accordingly, we understand that this construction is exempt from certificate of need review pursuant to G.S. 131E-184(g).

This project will "renovate, replace on the same site, or expand the entirety or a portion of an existing health service facility that is located on the main campus," defined in 131E-176(14n) as "[t]he site of the main building from which a licensed health service facility



Ms. Martha Frisone
August 28, 2017

provides clinical patient services and exercises financial and administrative control over the entire facility, including the buildings and grounds adjacent to that main building” and “[o]ther areas and structures that are not strictly contiguous to the main building but are located within 250 yards of the main building.”

The building from which Duke Raleigh Hospital, a licensed acute care hospital, provides clinical patient services and exercises financial and administrative control over the entire facility is the main hospital building located at 3400 Wake Forest Road. The new construction will be directly adjacent to and contiguous with this building, as set forth in the enclosed plans. Duke Raleigh Hospital’s license has been provided previously and can be submitted again upon request.

Please let me know if you have any questions about this project. We would appreciate your confirmation that this project is exempt from further review.

Very truly yours,



Catharine W. Cummer

MAIN
HOSPITAL

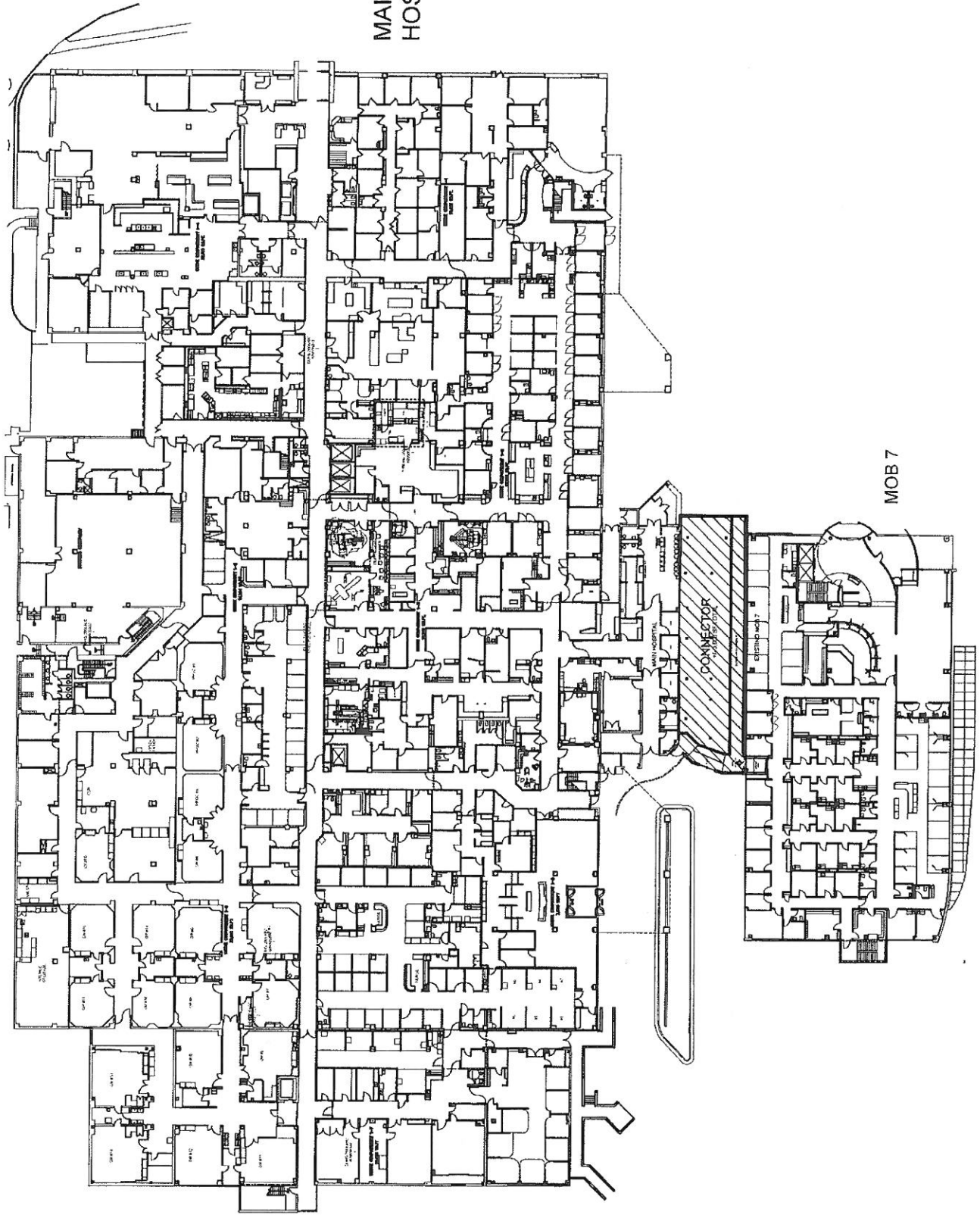

MOB 7

CONNECTOR

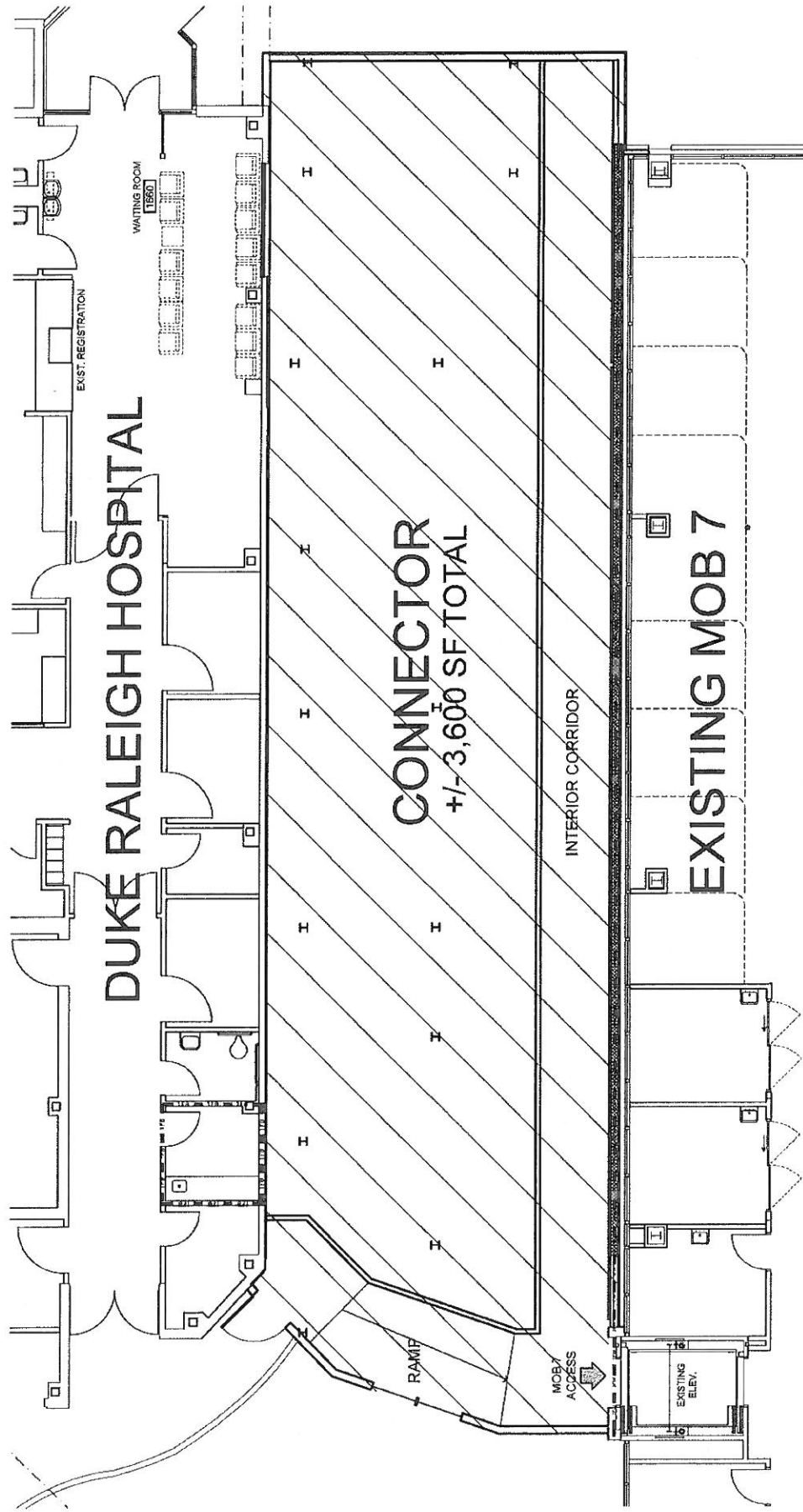

DUKE RALEIGH HOSPITAL

CONNECTOR
+/- 3,600 SF TOTAL

EXISTING MOB 7

EXIST. REGISTRATION

WAITING ROOM (1850)

INTERIOR CORRIDOR

RAMP

MOBY ACCESS

EXISTING ELEV.

Effective January 01, 2017, this license is issued to

Duke University Health System, Inc.

to operate a hospital known as

Duke Raleigh Hospital

located in Raleigh, North Carolina, Wake County.

*This license is issued subject to the statutes of the
State of North Carolina, is not transferable and shall remain
in effect until amended by the issuing agency.*

Facility ID: 923421

License Number: H0238

Bed Capacity: 186

General Acute 186

Dedicated Inpatient Surgical Operating Rooms: 0

Dedicated Ambulatory Surgical Operating Rooms: 0

Shared Surgical Operating Rooms: 15

Dedicated Endoscopy Rooms: 3

