



NC DEPARTMENT OF
**HEALTH AND
HUMAN SERVICES**

ROY COOPER • Governor
MANDY COHEN, MD, MPH • Secretary
MARK PAYNE • Director, Division of Health Service Regulation

VIA EMAIL ONLY

July 13, 2021

Catharine Cummer, Regulatory Counsel, Strategic Planning
catharine.cummer@duke.edu

No Review

Record #: 3607
Date of Request: June 30, 2021
Facility Name: Duke Raleigh Hospital
FID #: 923421
Business Name: Duke University Health System, Inc.
Business #: 640
Project Description: Relocate an operating room from the main hospital building to a medical office building on the hospital campus
County: Wake

Dear Ms. Cummer:

The Healthcare Planning and Certificate of Need Section, Division of Health Service Regulation (Agency) received your correspondence regarding the project described above. Based on the CON law **in effect on the date of this response to your request**, the project as described is not governed by, and therefore, does not currently require a certificate of need. If the CON law is subsequently amended such that the above referenced proposal would require a certificate of need, this determination does not authorize you to proceed to develop the above referenced proposal when the new law becomes effective.

This determination is binding only for the facts represented in your correspondence. If changes are made in the project or in the facts provided in the correspondence referenced above, a new determination as to whether a certificate of need is required would need to be made by this office.

NC DEPARTMENT OF HEALTH AND HUMAN SERVICES • DIVISION OF HEALTH SERVICE REGULATION
HEALTHCARE PLANNING AND CERTIFICATE OF NEED SECTION

LOCATION: 809 Ruggles Drive, Edgerton Building, Raleigh, NC 27603
MAILING ADDRESS: 809 Ruggles Drive, 2704 Mail Service Center, Raleigh, NC 27699-2704
<https://info.ncdhhs.gov/dhsr/> • TEL: 919-855-3873

AN EQUAL OPPORTUNITY / AFFIRMATIVE ACTION EMPLOYER

Ms. Cummer
July 13, 2021
Page 2

Please do not hesitate to contact this office if you have any questions.

Sincerely,

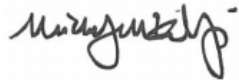

Michael J. McKillip
Project Analyst



Micheala Mitchell
Section Chief, Certificate of Need

cc: Construction Section, DHSR
Acute and Home Care Licensure and Certification Section, DHSR



Catharine W. Cummer
Regulatory Counsel, Strategic Planning

June 30, 2021

Via Electronic Mail

Ms. Lisa Pittman
Mr. Michael McKillip
Certificate of Need Section
Division of Health Service Regulation
2704 Mail Service Center
Raleigh, NC 27699-2704

Re: Exemption Notice/Duke Raleigh Hospital

Dear Ms. Pittman and Mr. McKillip:

The purpose of this letter is to provide notice of a renovation and operating room relocation project at Duke Raleigh Hospital and to request confirmation that this project is exempt from certificate of need review. As reflected in the attached floor plans, Duke intends to relocate the licensed operating room currently identified as OR 4 in the main hospital building to the eye procedure area in Medical Office Building 9. The current operating room is small and will be taken out of service in order to facilitate unrelated construction and renovation efforts. With the addition of a licensed operating room in MOB 9, the total number of licensed operating rooms will be unchanged.

MOB 9 is on the same grounds as the existing operating room and is not separated by more than a public right-of-way adjacent to the grounds where the operating room is currently located (see enclosed campus map). The total cost of the project to upfit space in MOB 9 to accommodate the operating room is less than \$2 million.

Based on these representations, we would appreciate your confirmation that this project is not subject to any certificate of need requirements. Please let me know if you have any questions.

Very truly yours,

Catharine W. Cummer

Catharine W. Cummer

Ms. Martha Frisone
Mr. Michael McKillip
March 9, 2020

Enclosures

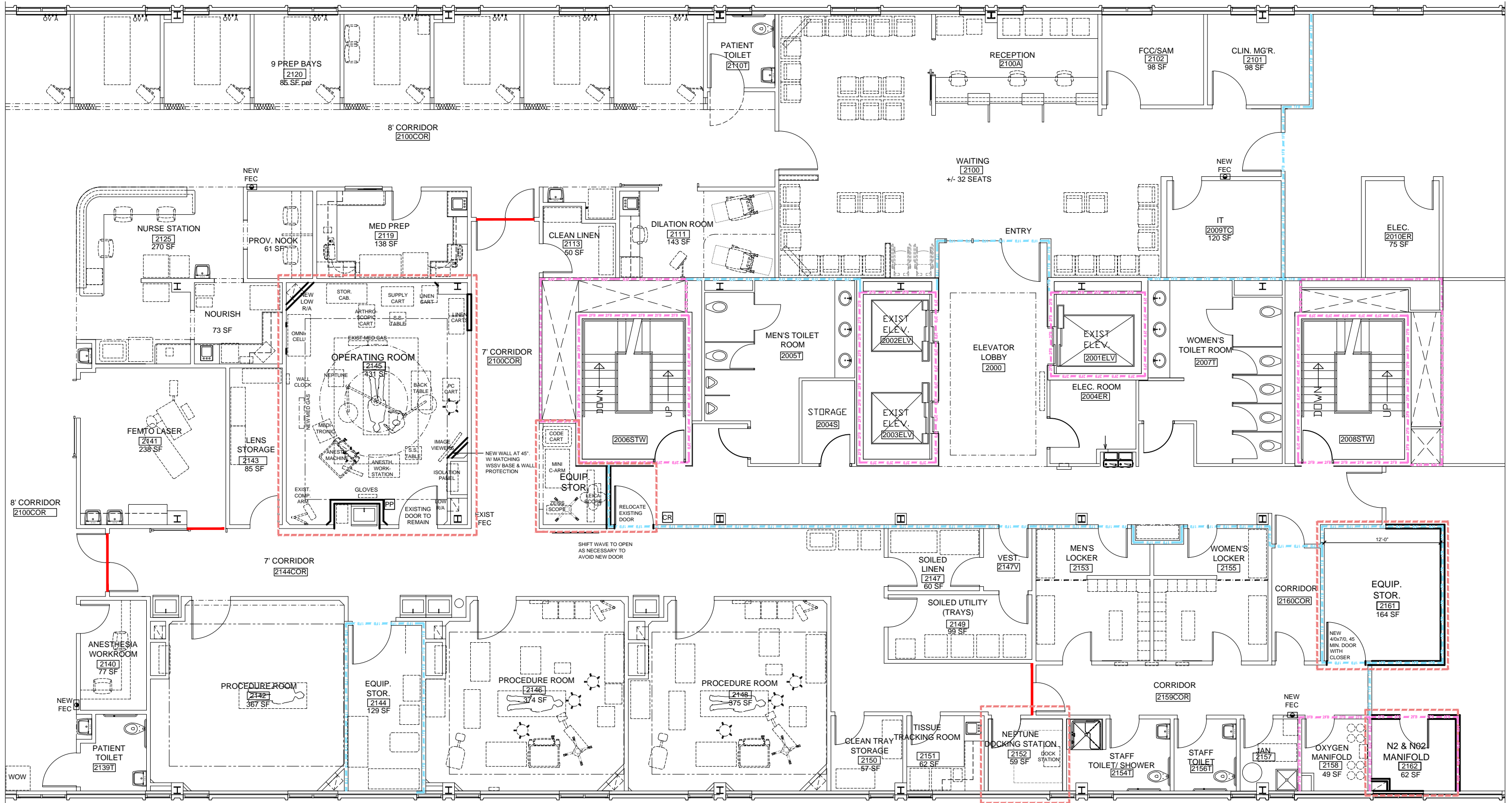

Duke Raleigh Hospital Surgery Suite

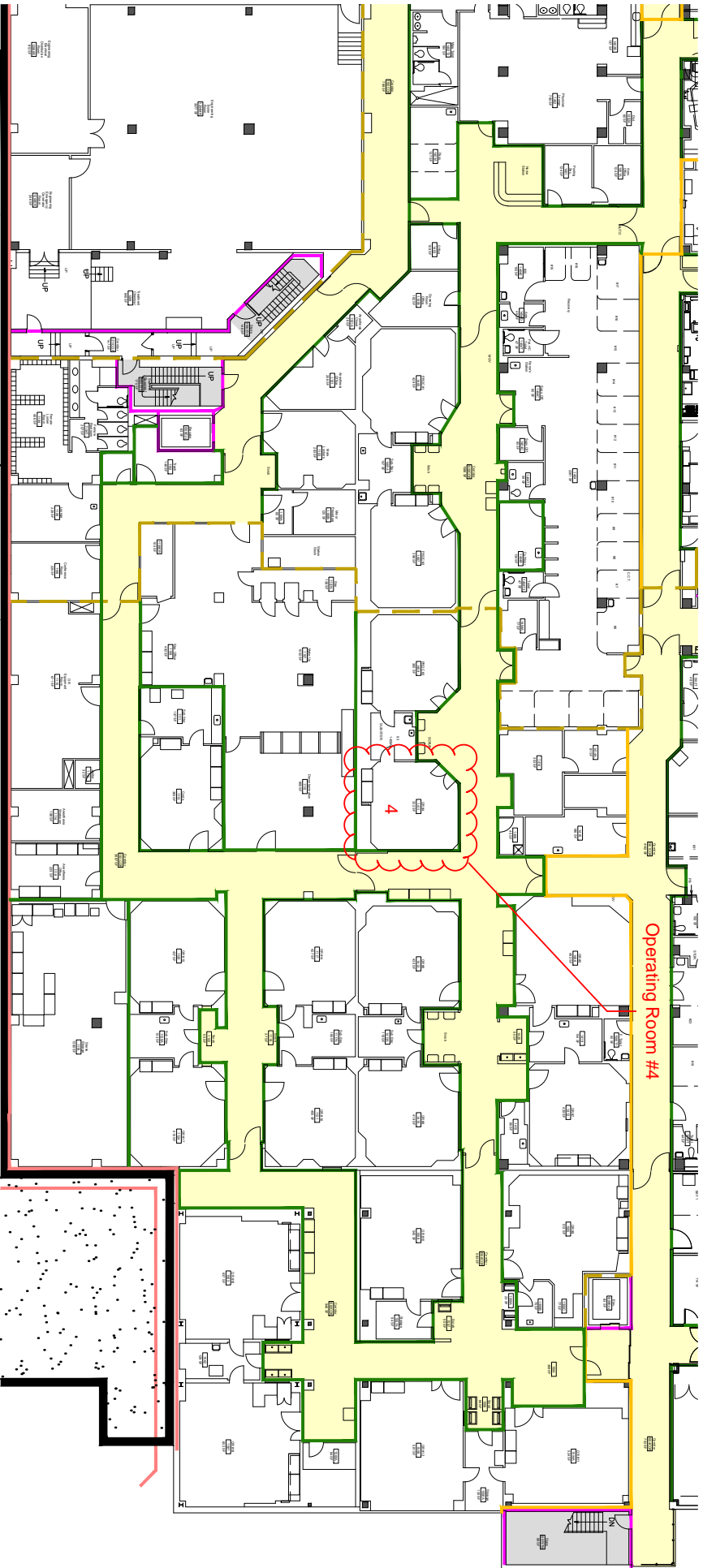

Benson Dr.



St. Albans Dr.

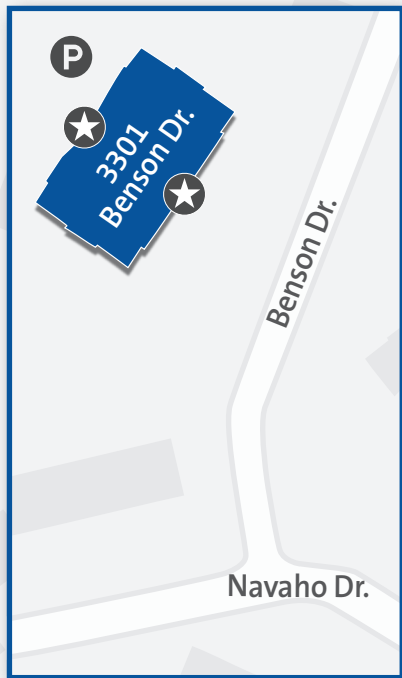

Wake Forest Rd.

3480 Wake Forest Rd.

P2 Parking Deck

Executive Dr.

Burningtree Place

3404 Wake Forest Rd.

MAIN HOSPITAL
3400 Wake Forest Rd.
North Pavilion

South Pavilion

3320 Wake Forest Rd.

3410 Executive Dr.

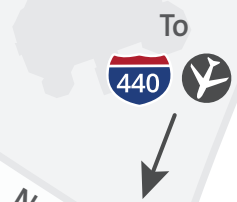

Navaho Dr.



P1 Parking Deck

3400 Executive Dr.

3320 Executive Dr.

- Building Entrances
- Parking
- Emergency Department
- Imaging Registration
- Bus Stop
- Gardens

Executive Dr.

3300 Executive Dr.